

Excerpt of Township Official Plan - Schedule B

Boundary of Subject Land

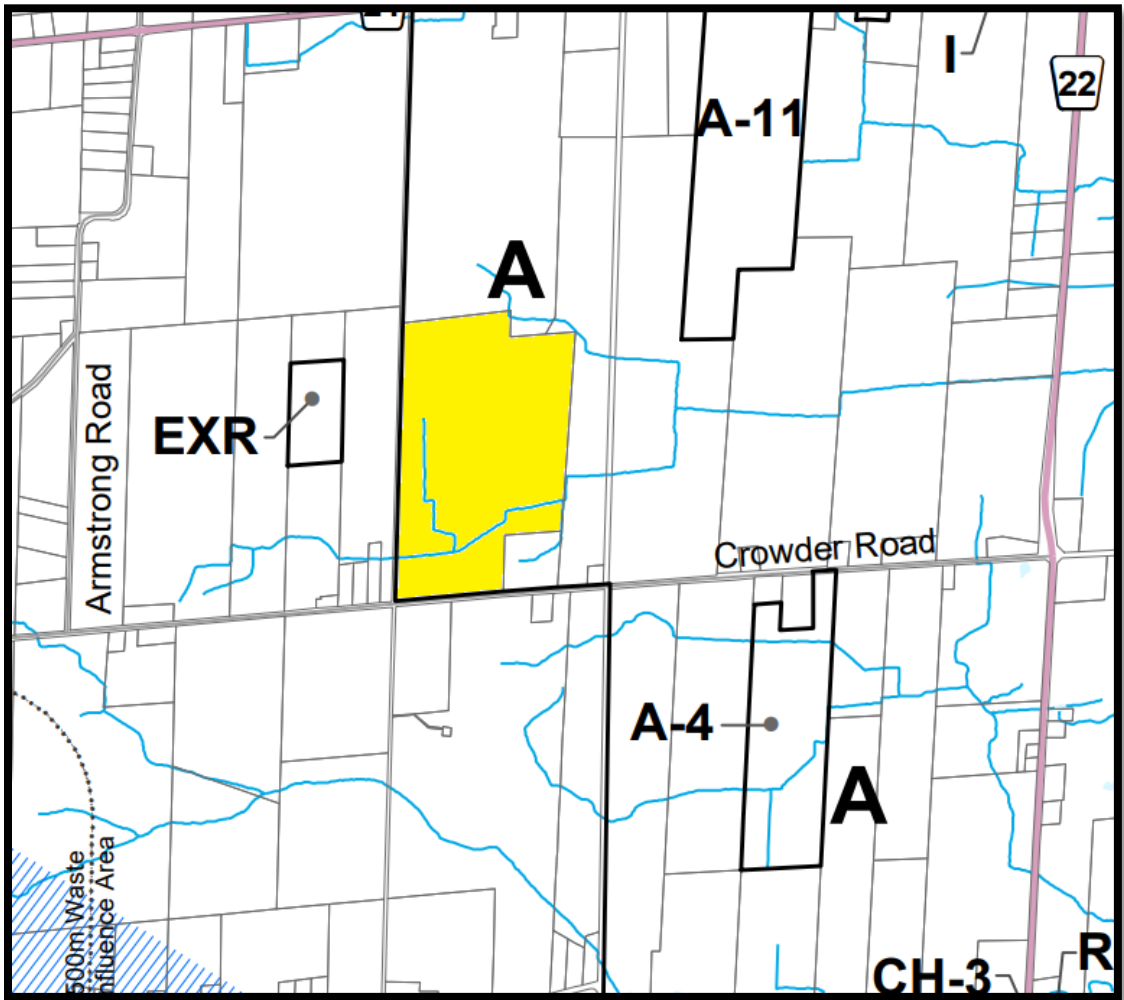

Overlay Zones

-  Flood Plain Overlay
-  Source Water Protection Overlay
 -  Intake Protection Zone Overlay (IPZ-1)
 -  Wellhead Protection Area A Overlay (WHPA-A)
 -  Wellhead Protection Area B Overlay (WHPA-B)
 -  Wellhead Protection Area C Overlay (WHPA-C)
-  Settlement Policy Area
-  Waterbody
-  Watercourse

  Within these areas certain Zoning By-law Provisions require that reference be made to the Official Plan

TRANSPORTATION

-  Provincial Highway
-  County Road
-  Township Road
-  Private Road
-  Active Railway
-  Abandoned Railway

Excerpt of Township Zoning Bylaw - Schedule A

 Subject Land

Agricultural





CON 6 PT
Lots 11 and 12 rp 1569412 PT
Part 1

Bush

municipal drain

Road Allowance unopened

-  Severed Lands w/ easement over driveway
-  Retained Lands

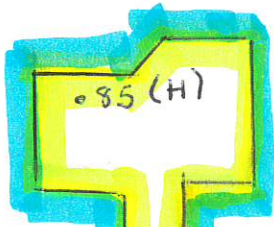

85 (H)

6.5 m

350 metres long

89 m

300 metres

11 metres access driveway to crowder

municipal drain

20m

crowder Rd

33

Road Allowance unopened

20m

Agricultural

0.76 FT
Lots 11 and 12



Road Allowance unopened

Road Allowance unopened

Bush

municipal drain

Bush

65.71 metres
Severed Area



20M

6.5 metres wide

municipal drain

Severed Lands
Retained Lands

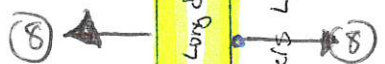

350 metres Long drive way

350 metres Long

89 metres

11 metre wide Driveway

300 metres

Residential - Agricultural

20M

Crowder Rd

1212 crowder Rd

N
↑

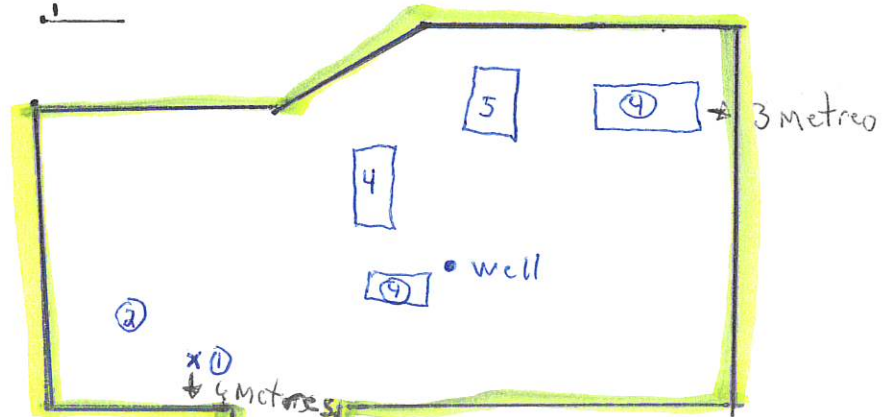

total Area is 8577metres

Legend

- 1. House
- 2. Septic
- 3. well - 30 metres from Lot Line
- 4. Sheds
- 5. Coverall
- 6. Driveway - 6.5metre wide
on to road at the Road its 11 metres
- 7. 11metres access onto crowder Rd
- 8. easement to retained land

Con 6
Lots 11 and 12

23
↑
↓

crowder Rd