



SOUTH EDWARDSBURGH RECREATION ASSOCIATION (SERA)

GREG MODLER - CHAIRPERSON

DAVID JANSEN - SECERTARY

Introduction & SERA History

- ▶ SERA was established in 1973, making it the oldest recreational group still operating in Edwardsburgh.
- ▶ SERA has provided both financial and volunteer support for numerous key projects, demonstrating our deep commitment to enhancing the quality of life for residents. A focus which aligns with the strategic vision of both groups
- ▶ A History of Significant Investment: SERA has made substantial financial contributions to key community assets, including a \$54,000 contribution towards the construction of the Community Centre, swimming pool, ball diamonds, tennis courts, playground, and related equipment. Additionally, SERA built and donated the gazebo by the pool in 1996 (\$8,000) and fully funded the creation of Millennium Park in 2000 (\$10,000). These contributions underscore SERA's long-standing commitment to enriching recreational opportunities in the area.



Our Commitment to Community Recreation



- ▶ The South Edwardsburgh Recreation Association (SERA) is a dedicated group of volunteers committed to enhancing recreational opportunities and fostering community engagement within Johnstown & TWPEC.
- ▶ We actively collaborate with the Township to improve local facilities and organize events that bring our community together.
- ▶ 2025/2026 Events Include
 - ▶ NYE Party
 - ▶ Community Cleanup Day
 - ▶ Community BBQ
 - ▶ Community Yard Sale
 - ▶ Trunk or Treat
 - ▶ Dog Park Social
 - ▶ Chilifest
 - ▶ Paint Night/Flower Arrangement
 - ▶ Strong Partners with TWPEC on Bar Management/Pool Operations/Swim Lifeguard Programs

EASTER FLOWER ARRANGEMENTS *Workshop*



You need to bring:

- 6" - 8" basket/container with a liner OR a medium vase.
- Gloves.
- Sharp snips or knife.

You will receive:

- Oasis for container arrangement.
- A kit with 8-10 flower stems, greenery and accents.
- Guided instructions and hands on help.

Available for purchase (transfer):

- A selection of baskets/containers.
- Handmade Easter picks and bows.



🐾 Dog Park Social 🐾

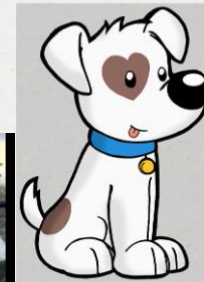

When: Saturday June 1st
Time: 1:00-3:00 pm
Where: Johnstown Dog Park
(24 Sutton Drive)

The Pavilion Project - Enhancing Our Parks



- ▶ Following the recent successful upgrades to the ball diamond lighting and the pickleball/tennis courts by the Township, SERA is eager to contribute further to our community's recreational landscape which is where the Pavillion Project is focused. SERA wants to continue to grow the infrastructure in the park for residents and visitors.
- ▶ We believe this pavilion will be a valuable addition to the park, supporting future developments and enriching the overall user experience.
- ▶ We envision an approximately 30' x 30' open structure that will provide much-needed shelter and a gathering space for park users. We have preliminary engineered drawings completed however exact design can be modified

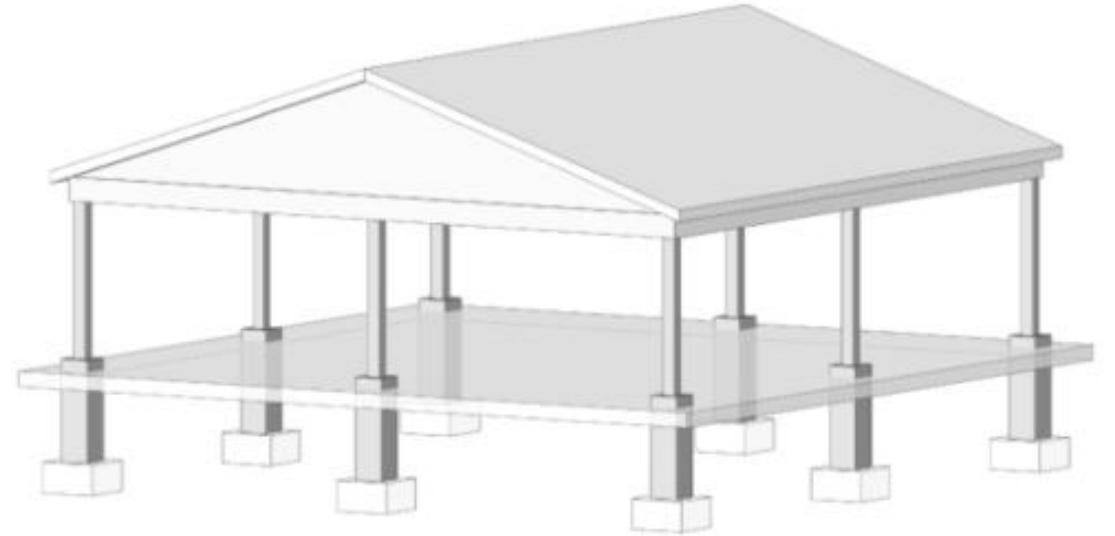

Our Plan and TWPEC Requests



SERA Plan:

- ▶ Complete Preliminary Design
- ▶ Support of TWPEC for Project
- ▶ Preliminary Quotations for Budget
- ▶ Fundraising
- ▶ Permitting/Construction

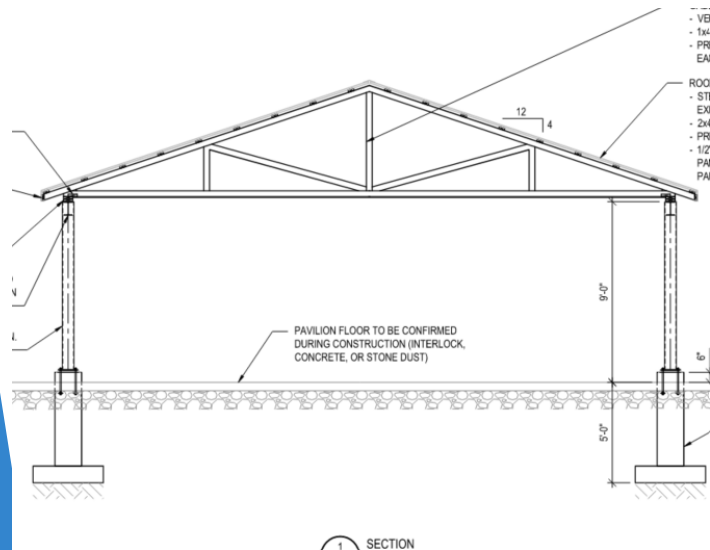

Requests of TWPEC:

- ▶ **Acceptance in principle** of the SERA Pavilion Project, to be constructed on TWPEC Property.
- ▶ Agreement that **TWPEC will take ownership** of the completed pavilion, with SERA's ongoing support
- ▶ That **construction funding be billed through the Municipality** to leverage the Municipal HST Rebate for cost optimization.
- ▶ That **TWPEC hold the funding during fundraising** and that SERA work with with the Treasury/Finance team to **issue official donation receipts** for both cash and in-kind contributions, in accordance with CRA guidelines
- ▶ While construction in 2025 is unlikely without exceptional fundraising success, we request consideration a **financial support from either or both the PoJ and TWPEC** within the 2026 budgets.

Thank You & Questions

SERA is excited about the potential of this pavilion to enhance our community's recreational spaces. We are committed to working collaboratively with TWPEC throughout this project.

